

Model 124

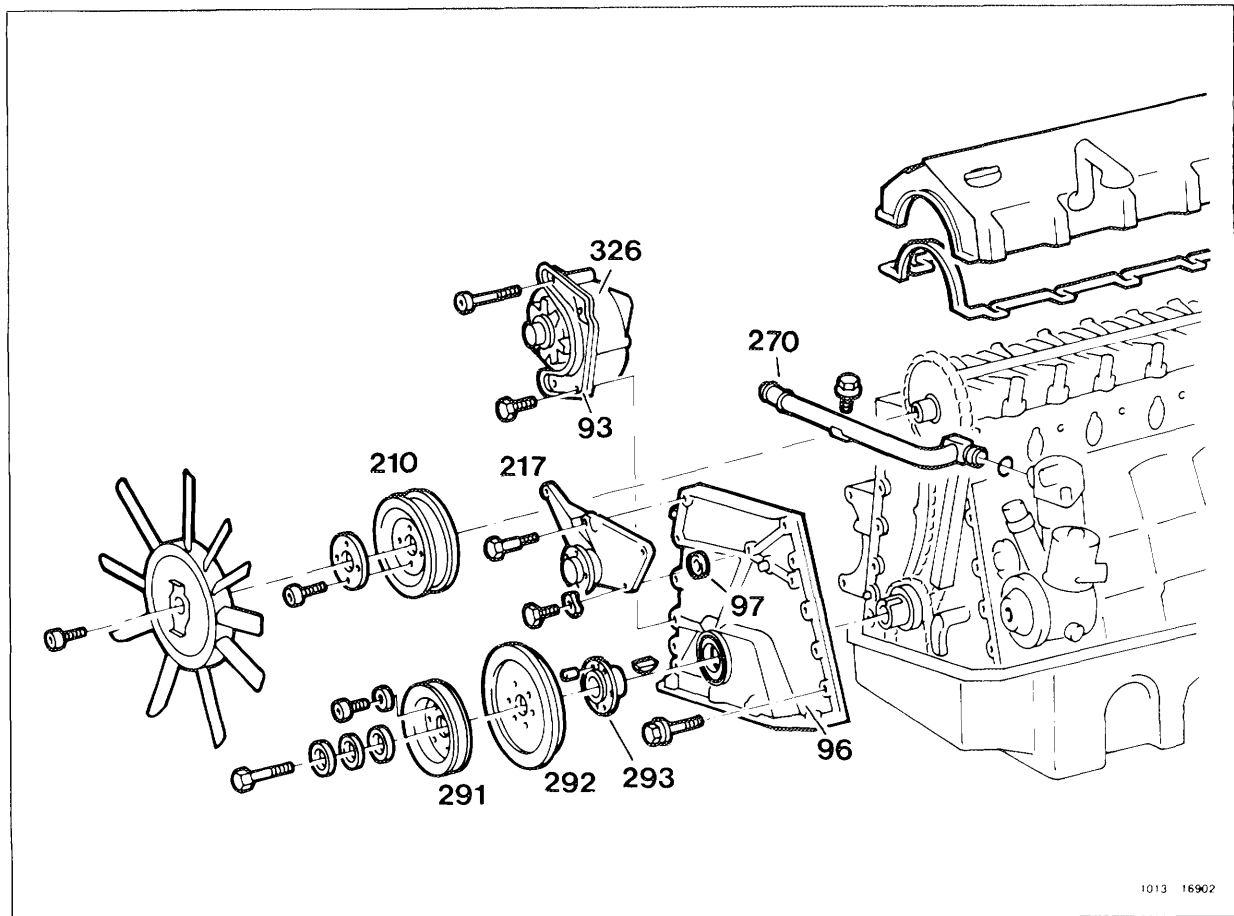

Hood	set vertical (01-008).
Ground cable at battery	disconnect, reattach.
Air filter and air scoop	remove, install (09-400).
Engine compartment lower cover	remove, install (step 5).
Radiator	remove, install (20-420).
Viscous fan clutch	remove, install (20-312).
Fastening bolts of belt pulleys:	
Fan clutch, coolant pump, tandem pump	loosen, tighten, 10 Nm.
Poly V-belt	remove, install (13-342).
Belt pulley: fan clutch (210), coolant pump, tandem pump	take off, reinstall (step 10).

Belt pulley (291), vibration damper (292) and hub (293)	remove, install (03-342).
Heating water return line (270)	detach, attach and place to one side (step 12).
Level control line	detach, attach and place to the side (step 13).
Front top cover	remove, install (01-212).
Tensioner bracket	loosen, swivel, seal and secure (step 15).
Tandem pump	unbolt, bolt on(step 16).
Fan bearing support(217)	remove, install, 21 Nm (step 17).
Sealing ring (97)	replace (step 24).
Alternator (326) with bracket (93) and TDC sensor	remove, install (steps 18 and 19).
Chain tensioner	remove, install (05-310).
Timing cover (96) front lower	unbolt, replace M6 10 Nm, M8 21 Nm (step 22).
Timing cover (96) with TDC sensor bracket	remove, seal and replace.

Tightening torques

Fastening bolts of oil pan		10 Nm
Timing case cover to crankcase	M6	9 Nm
	M8	21 Nm
Belt pulley to coolant pump shaft		10 Nm
Belt pulley to tandem pump		10 Nm

Special tool

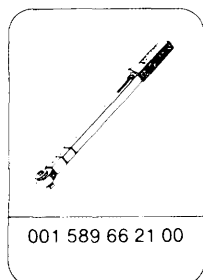

Removal, installation

- 1 Set hood vertical (01-008).
- 2 Disconnect battery ground cable.
- 3 Unscrew bolt (338). Pull air scoop (339a) from air filter in direction of arrow and remove.
- 4 Remove, install air filter (09-400).

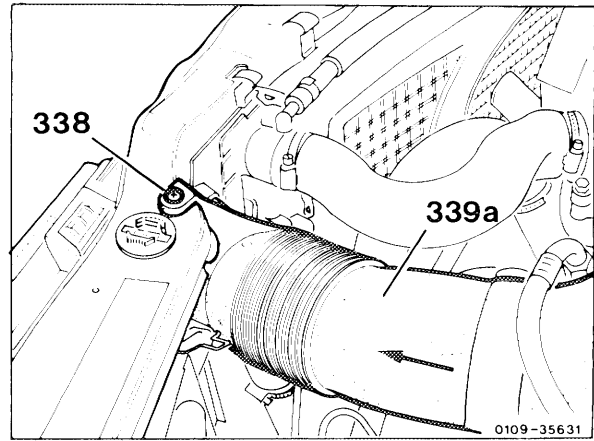

- 5 Unscrew bolts (504) and take off engine compartment covering (505).
- 6 Remove radiator (20-420).
- 7 Remove viscous fan clutch (20-312).

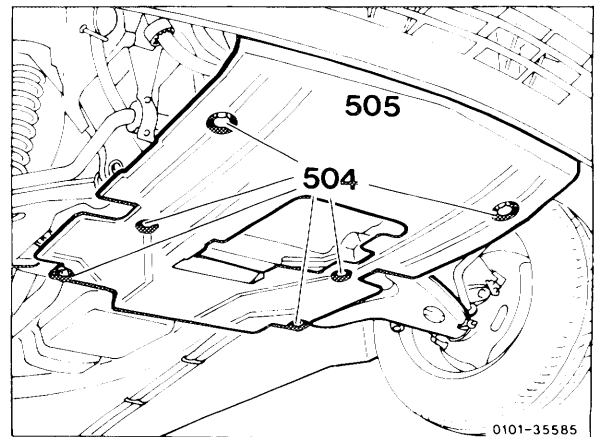

- 8 Loosen bolts (arrows).
- 9 Remove poly V-belt (13-342).
- 10 Unscrew bolts (arrows), tightening torque 10 Nm.
Take off belt pulleys from fan clutch (210), coolant pump (273) and tandem pump (284).

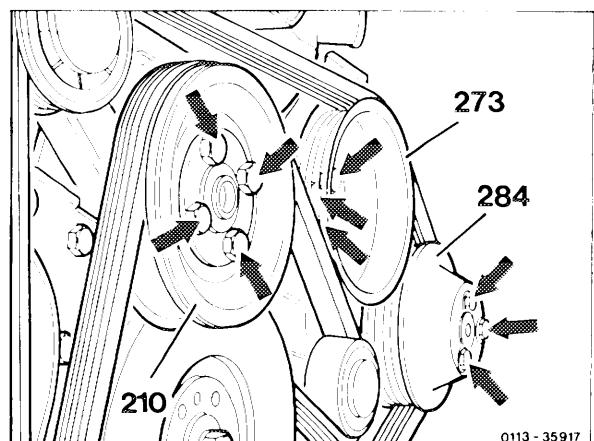

- 11 Remove belt pulley, vibration damper and hub (03-342).

12 Loosen bolt (271). Withdraw heating water return line (270) from coolant pump and place to one side. Unscrew nut (225) and withdraw bolt (218) from the front.

Note:

Effective 10/1987, the heating water return line is also bolted to the coolant pump.

Installation note:

Replace heating water return line seal (270).

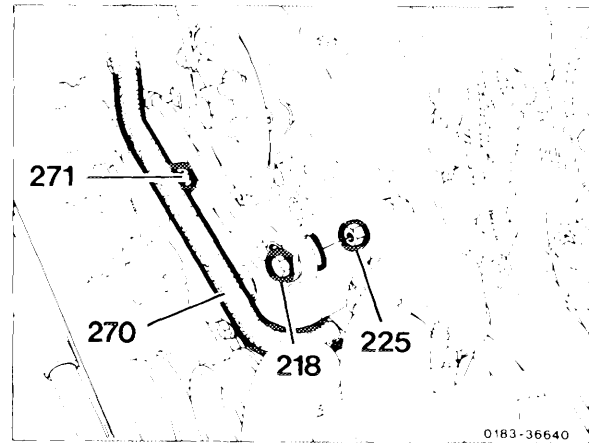

13 With self-levelling suspension, loosen clip (arrow). Detach hose (275) and plug line (608).

14 Remove front upper cover (01-212).

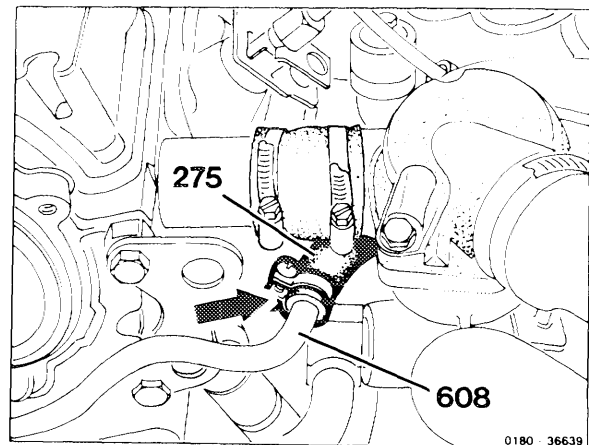

15 Loosen bolt (211) and remove bolts (215, 651, 652) together with spring washers. Swivel bracket (213).

Note:

Hold nut of bolt (651) to prevent it turning.

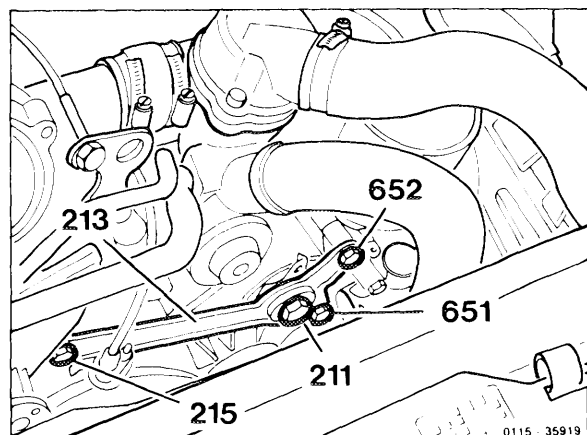

Installation note:

Apply sealant 001 989 29 20 to the front and rear sides of the attachment hole (arrow) of the bracket (213).

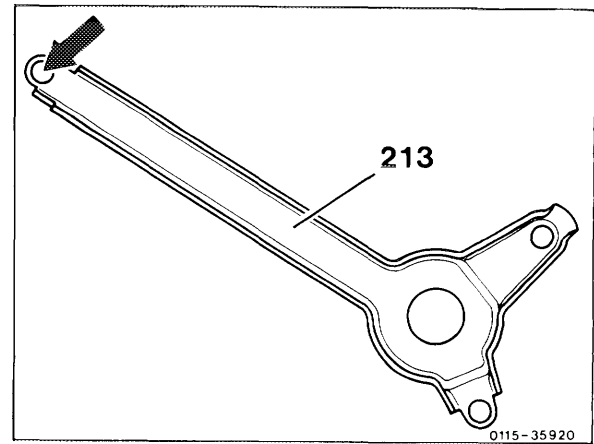

16 Unscrew bolts (277, 278). Swivel tandem pump (280) in direction of arrow.

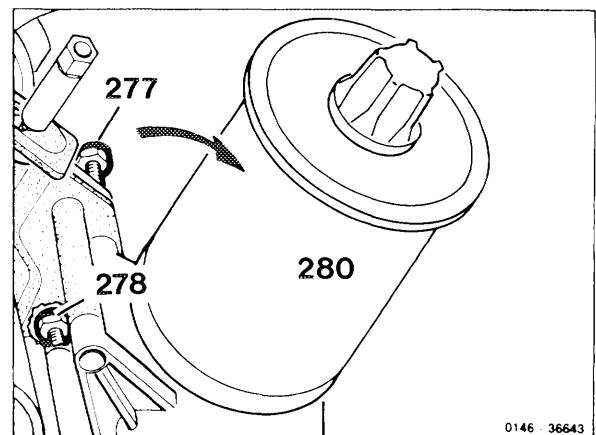

17 Unscrew bolts (214), tightening torque 21 Nm, and remove fan bearing support (217). Unscrew nut (99). Take off TDC sensor (100) together with cable and place to one side.

Note

TDC sensor bracket (102) remains on timing case cover.

If replacing timing case cover, adjust TDC sensor.

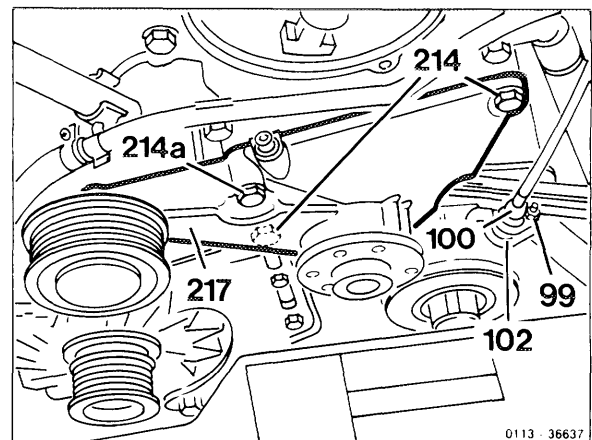

18 Disconnect wiring connector at the alternator (326).

19 Unscrew bolts (91, 92). Remove bracket (93) and alternator (326).

20 Remove chain tensioner (05-310).

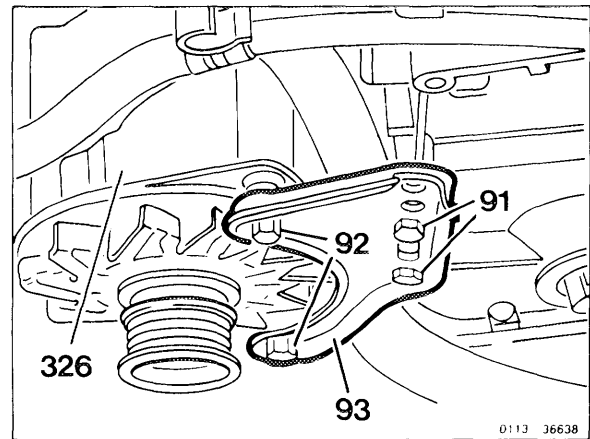

21 Unscrew bolts (138), tightening torque 10 Nm, and bolts (139), tightening torque 21 Nm, on the oil pan.

With self-levelling suspension: Place retaining clip with high-pressure hose to the side.

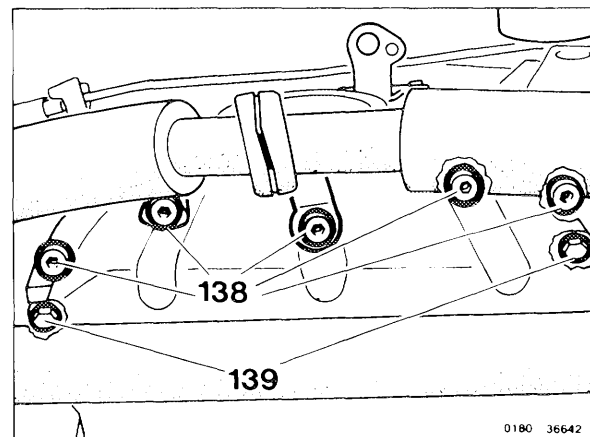

22 Unscrew bolts (95, 105) and remove timing case cover (96).

Note:

Do not damage oil pan gasket!

If necessary, replace oil pan gasket.

Check crankshaft front seal (295); renew if necessary.

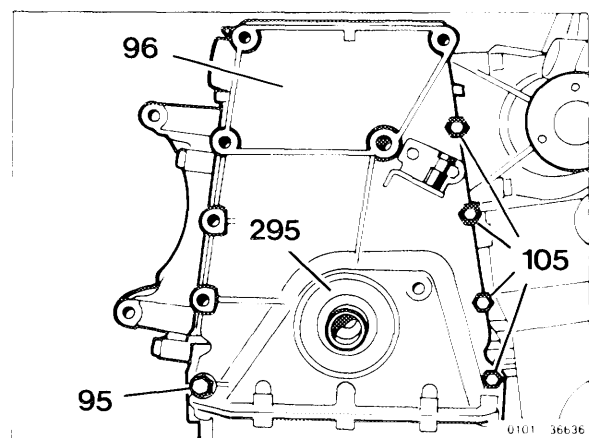

23 Clean sealing surfaces on crankcase and on timing case cover.

Apply an even coat of sealant 001 989 45 20 to sealing surface of timing case cover.

4MATIC: Also, clean sealing surfaces of oil pan and coat with sealant 001 989 61 20 10.

Note

The timing case cover is held in place by two roll pins in the engine block. Do not damage oil pan gasket.

Tightening torque 10 Nm.

Timing case cover to engine block:

M6 : 9 Nm

M8 : 21 Nm

24 Replace seal (97).

25 Install in reverse sequence.

26 Check engine oil level in and top up if needed.

27 Check engine for leaks with engine running.

